

PARTIAL SECT A-A

DETAIL OF D,E (5:1)

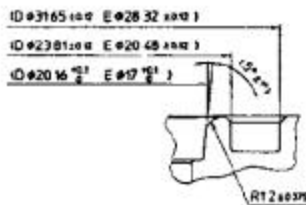

PARTIAL SECT B-B

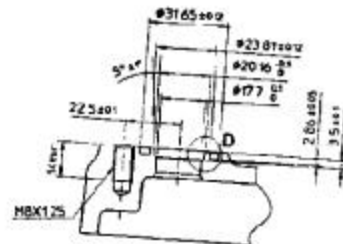

PARTIAL SECT C-C

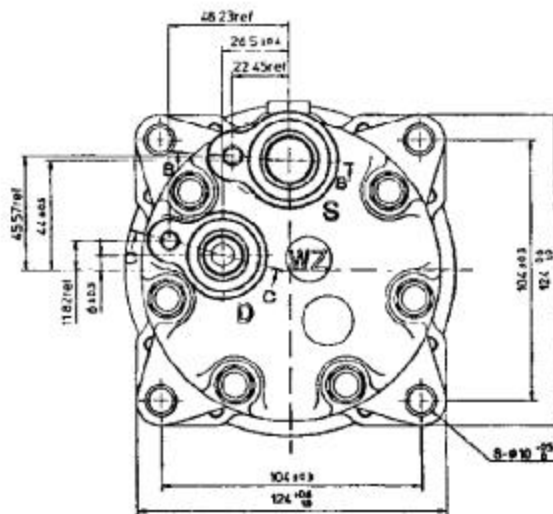
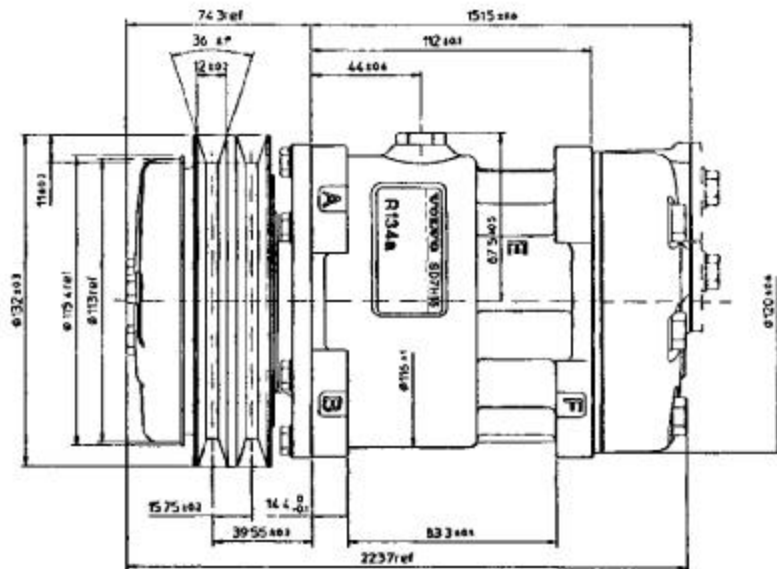

COMPRESSOR SPECIFICATIONS

BORE	#29.3	mm
STROKE	32.8	mm
NUMBER OF CYLINDERS	7	
DISPLACEMENT PER REVOLUTION	154.9	cc/rev
MAXIMUM ALLOWABLE CONTINUOUS SPEED	5000	r.p.m.
MAXIMUM DOWNSHIFT SPEED	5000	r.p.m.
REFRIGERANT	R134a	
OIL	SP-10 OR EQUIVALENT	
OIL CHARGE	240	cc
ROTATION (CLUTCH SIDE VIEW)	CLOCKWISE	
WEIGHT		kg

CLUTCH SPECIFICATIONS

RATED VOLTAGE	DC 24 V
MINIMUM BREAKAWAY TORQUE	35 kg m
MINIMUM ENGAGEMENT VOLTAGE	DC 16 V
MAXIMUM POWER CONSUMPTION	42 W (Cu)
MAXIMUM ALLOWABLE CONTINUOUS SPEED	5000 r.p.m.
MAXIMUM DOWNSHIFT SPEED	5000 r.p.m.
BELT TYPE	A TYPE
PULLEY DIAMETER	#132 mm
WEIGHT	kg

PORT O-RING P/N

SUCTION O-RING	3094874 (8603-0500)
DISCHARGE O-RING	3094875 (8664-0500)

BOLT SURFACE TREATMENT SPECIFICATION

Fe/Zn 5+ BLACK CHROMATE

PART NO.		DATE		SCALE		NAME	
COMPRESSOR		1 1		1 1		COMPRESSOR	
DRAWN BY		DATE		SCALE		NAME	
CHECKED BY		DATE		SCALE		NAME	
APPROVED BY		DATE		SCALE		NAME	
REVISION RECORD		BY		DATE		REVISION	
						SD7H15WZ8045	
						8045 - 6000	