

PARTIAL SECT. A-A

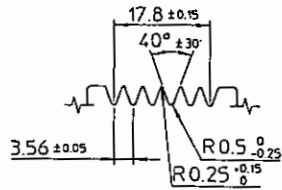

DETAIL OF ROTOR GROOVE(2:1)

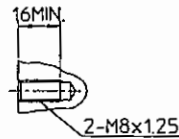

PARTIAL SECT. C-C

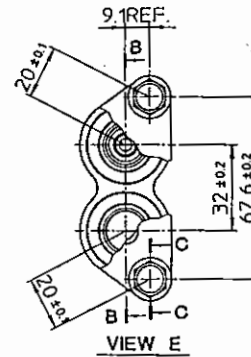

VIEW E

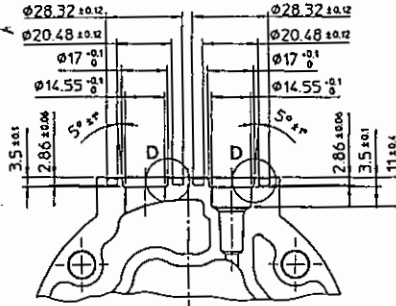

PARTIAL SECT. B-B

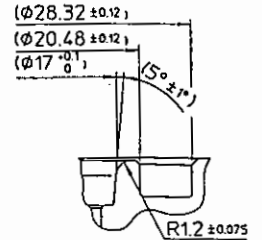

DETAIL OF D (5:1)

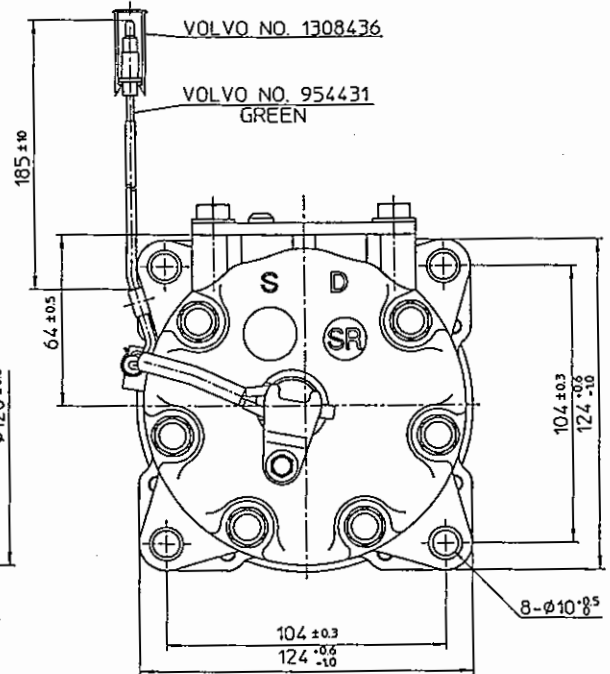
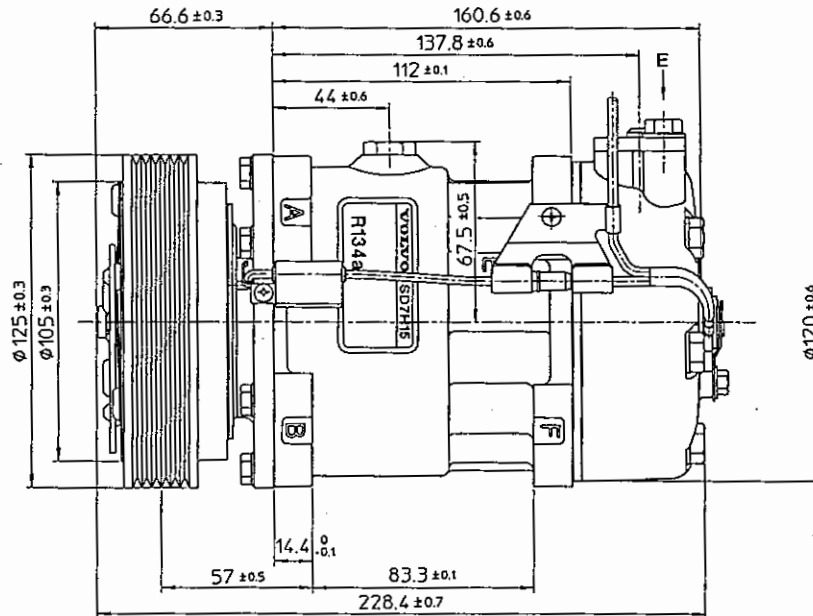
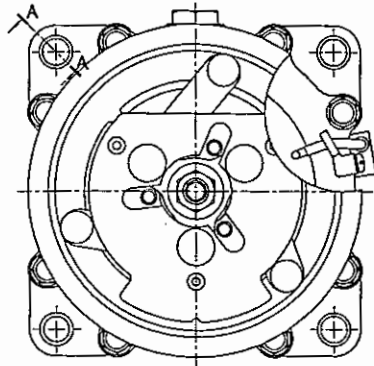

COMPRESSOR SPECIFICATIONS

BORE	29.3	mm (1.15 in.)
STROKE	32.8	mm (1.29 in.)
DISPLACEMENT PER REVOLUTION	54.9	cc/rev. (9.5 cu.in./rev.)
NUMBER OF CYLINDERS	7	
MAXIMUM ALLOWABLE r.p.m.	7000	r.p.m.
MAXIMUM ALLOWABLE CONTINUOUS r.p.m.	6000	r.p.m.
REFRIGERANT	R-134a	
OIL : SANDEN SP-20	240	cc (8.2 fl.oz.)
WEIGHT	5.0	kg (11.0 lb)

CLUTCH SPECIFICATIONS

RATED VOLTAGE	DC 12 V
BREAKAWAY TORQUE	35 kg-m (25.3 ft.-lb)
MINIMUM ENGAGEMENT VOLTAGE	7.5 V MAX.
POWER CONSUMPTION	49 W (CU)
MAXIMUM ALLOWABLE r.p.m.	7000 r.p.m.
MAXIMUM ALLOWABLE CONTINUOUS r.p.m.	6000 r.p.m.
BELT TYPE	PV TYPE
PULLEY DIAMETER	125 mm (4.9 in.)
WEIGHT	2.6 kg (5.7 lb)

THERMAL PROTECTOR SPECIFICATIONS

TYPE	BIMETAL
CUT OFF TEMPERATURE	115°C ± 3°C
DIFFERENTIAL	15°C REF.
CUT IN TEMPERATURE	100°C ± 6°C

BOLT SURFACE TREATMENT SPECIFICATION
Fe/Zn 5µ BLACK CROMATE

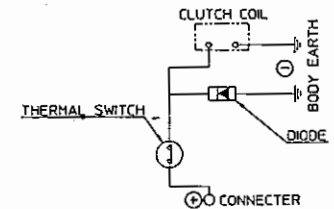

CIRCUIT DIAGRAM

NOTE

- 14 mm RECESS
- O-RING FOR FRONT HOUSING SEAL

MATERIAL	PART NO.	7935	NAME	COMPRESSOR
DESIGN BY	SCALE	1:1	MODEL	SD7H15SR7935
CHECKED BY	DATE	5 Oct. 1993	DRAWING NO.	7935-6000
CHECKED BY	DATE	5 Oct. 1993		